

# ATOMS™ GARAGE DOOR OPENER

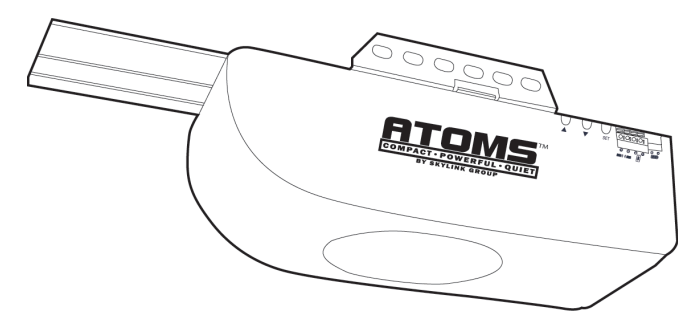

- IMPORTANT:**
- Veuillez lire attentivement ce guide et les consignes de sécurité jointes qui l'accompagnent.
  - Safety Infrared Sensor **MUST** BE INSTALLED and aligned properly.
  - Periodic checks of the opener are required to ensure safe operation.
  - Save this manual for future reference.
  - This Equipment meets or exceeds all Federal, State and UL325 Safety Requirements.

**DO NOT RETURN TO THE STORE**

ENGLISH  
PAN-101Y428

## ASSEMBLE THE T-RAIL

**1. Connect the T-Rail Sections**  
Align the 4 T-rail sections on the floor. Connect these rails together with the rail couplers as shown. All rail pieces must be aligned properly.

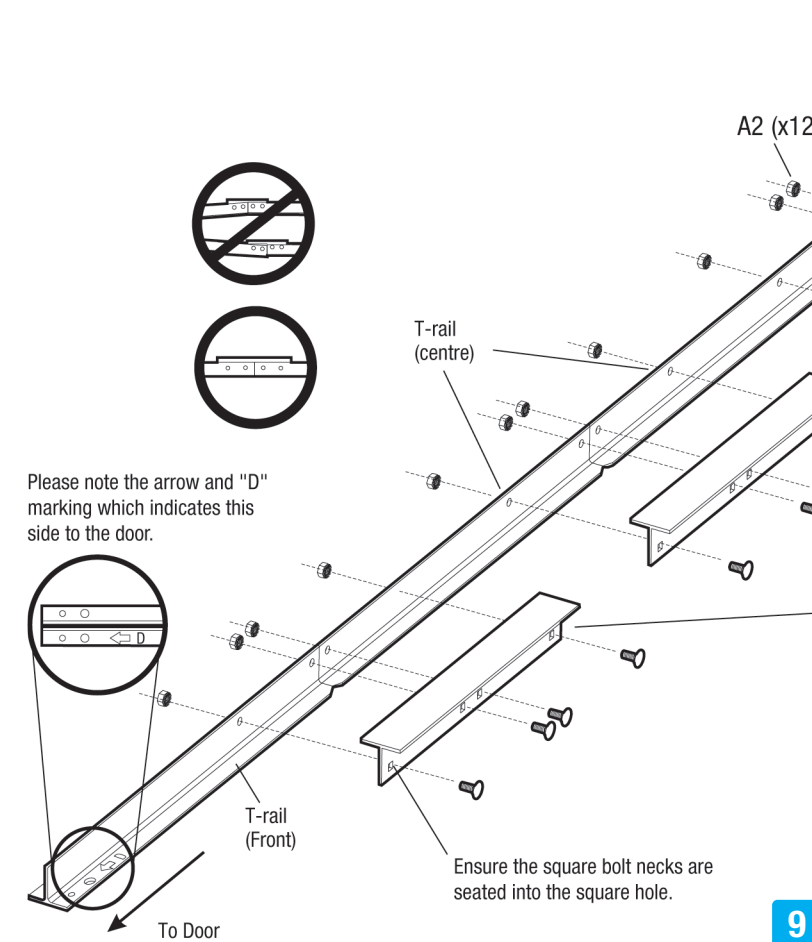

## ASSEMBLE THE T-RAIL

Please note the arrow and "M" marking which indicates this side to the motor unit.

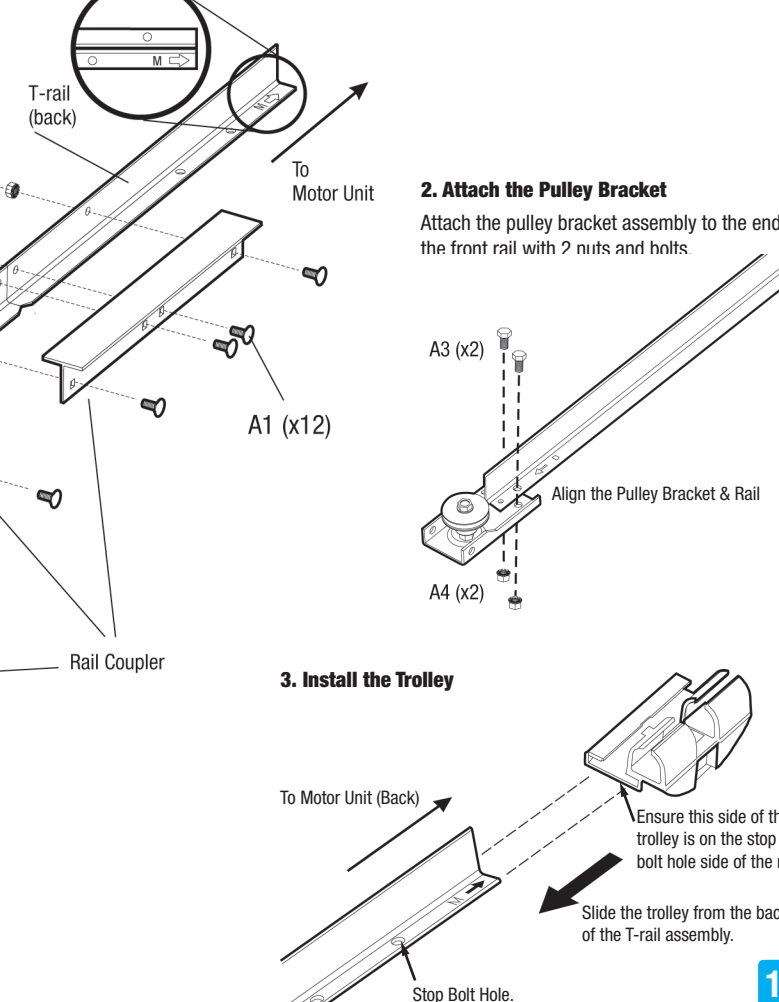

## HANG THE OPENER

**1. Raise the Opener**  
Raise the opener onto a stepladder. Use extra spacers on top of the ladder if the ladder is not tall enough.

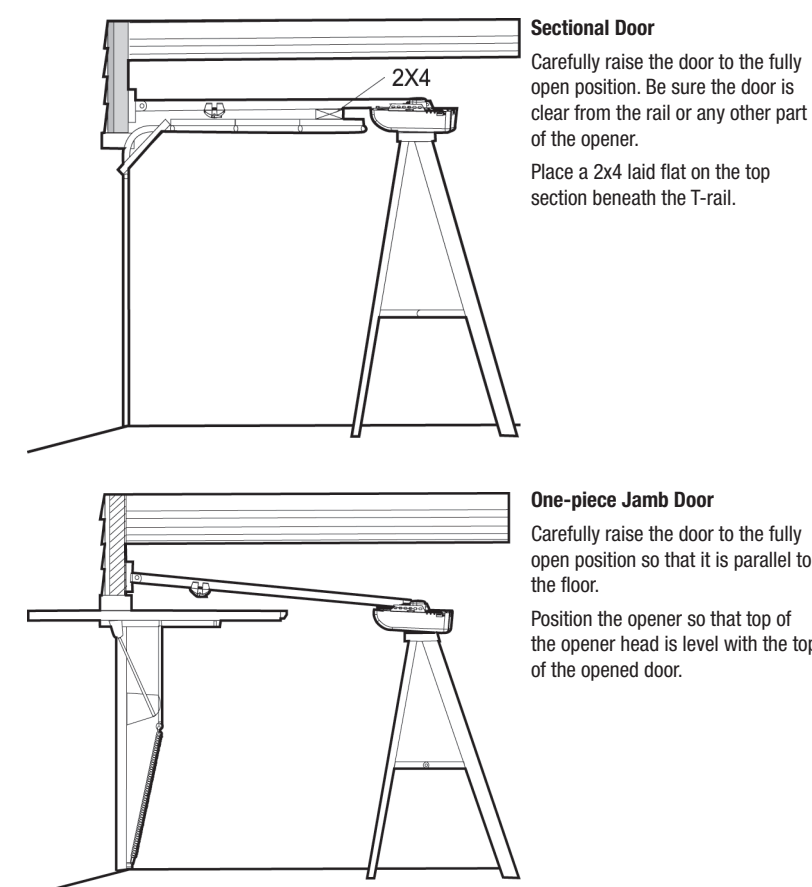

## HANG THE OPENER

**2. Attach the Hanging Brackets**  
Hanging brackets should be angled to provide rigid support. Measure the distance from the motor unit to the structural support. Cut and bend the hanging brackets as required.

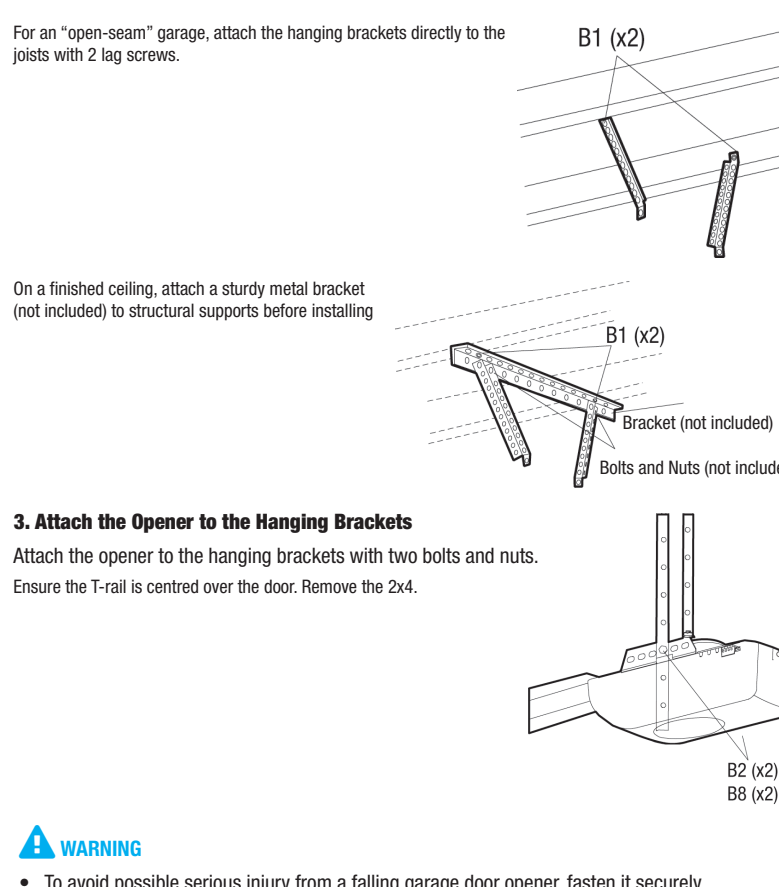

## CONNECT THE OPENER TO POWER

**1. Connect AC Power**  
Plug motor unit into grounded outlet. If a grounded outlet is not available, contact a qualified electrician to install a proper outlet. **DO NOT ACTIVATE THE OPENER UNTIL INSTRUCTED.**

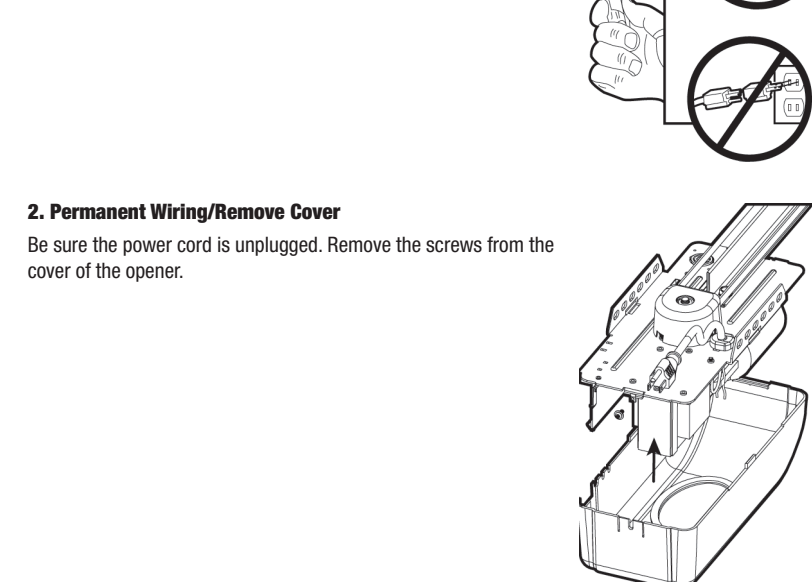

- WARNING**
- If permanent wiring is required by your local code, have a licensed electrical contractor follow the procedures outlined in this manual. Disconnect power to the circuit before removing cover.
  - Be sure power is not connected to the opener and disconnect power to circuit before removing cover to establish permanent wiring connection.
  - Garage door installation and wiring must be in compliance with all local electrical and building codes.
  - Never use an extension cord, 2-wire adaptor, or change plug in any way to make it fit. Be sure the opener is grounded.
  - The opener has a grounded type plug for your protection and only fit into a grounding type outlet. Do not change the plug in any way.

## CONNECT THE OPENER TO POWER

**3. Permanent Wiring/Remove the Power Cord**

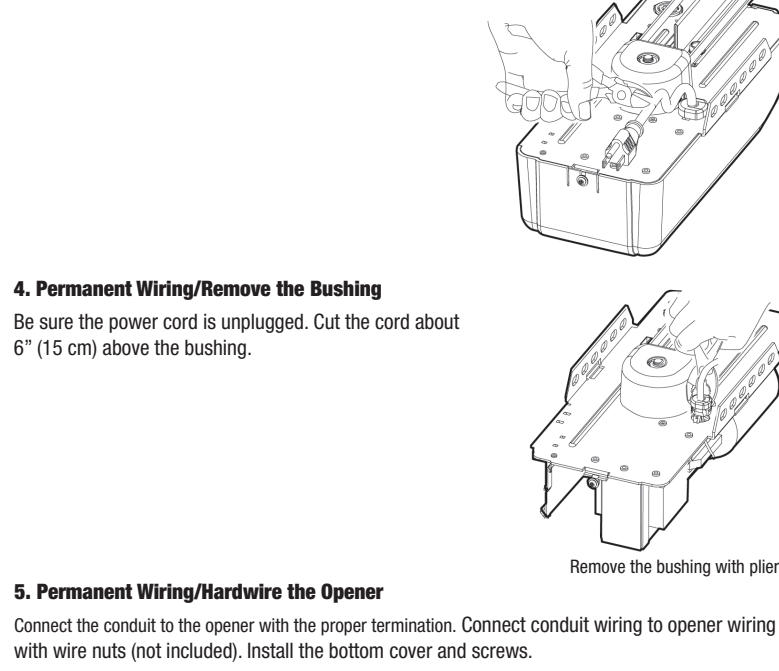

- 4. Permanent Wiring/Remove the Bushing**  
Be sure the power cord is unplugged. Cut the cord about 6" (15 cm) above the bushing.
- 5. Permanent Wiring/Hardwire the Opener**  
Connect the conduit to the opener with the proper termination. Connect conduit wiring to opener wiring with wire nuts (not included). Install the bottom cover and screws.
- Green – Ground  
White – Neutral  
Black – Hot

CONGRATULATIONS on your purchase of Skylink Garage Door Opener, a garage door opener with many innovative features. Features include extremely quiet operation with DC motor; automatic force adjustment so the door can be closed with just the right amount of force, not overpowered; state of the art safety reversal systems that protect your family and property near the door.

**Important Safety Information**  
This documentation provided with your opener has been carefully designed and organized to make the assembly, operation and continued maintenance of your product as easy and safe as possible, provided it is installed, operated, maintained and tested in strict accordance with the instructions and warnings contained in this manual. Read and follow all guidelines and operating instructions before the first use of this product. Store the manual in a safe, easily accessible location.

- Safety Symbol Overview**
- WARNING**
    - This type of warning symbol is used to indicate possible mechanical hazards that may cause serious injuries or death.
  - CAUTION**
    - This type of warning symbol is used to indicate the possibility of damage to the garage door or opener.

## PRE-INSTALLATION CHECKLIST

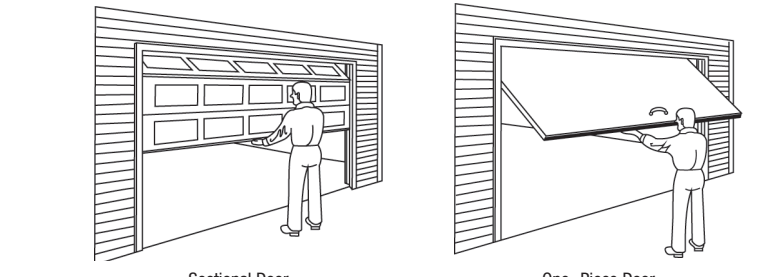

- Check the following items before assembling the opener:
- Identify the door type: sectional door or one-piece jamb door.
  - Ensure your garage door is balanced and is not sticking or binding.
  - Here is how to check the door balance:
    - From outside the garage, slowly open the door all the way and close it all the way – DOOR SHOULD NOT BIND OR RUB.
    - Raise the door halfway up – DOOR SHOULD STAY IN PLACE, SUPPORTED ENTIRELY BY ITS SPRING.

- IMPORTANT**
- IF THE GARAGE DOOR FAILS EITHER OF THESE TESTS, HAVE A QUALIFIED GARAGE DOOR PROFESSIONAL ADJUST OR REPAIR THE DOOR.
  - If the garage door is lightweight (made with frame and skin, not solid), it must be braced or reinforced before installing the opener (including the door frame). Check with a qualified service professional for a door reinforcement kit.
  - If you do not have an access door in addition to the garage door, you should install an emergency key release kit.
  - If your door is more than 7' (2.1 m) high, you will need a rail extension kit (sold separately).
  - With the garage door closed, check alignment of door and garage floor. The gap, if any, should be no more than 1/4" (6 mm). If the gap is larger than this, repair floor or door before installing opener.

## ASSEMBLE THE T-RAIL

**7. Align the Chain on the Sprocket**  
Start aligning the chain by placing the turnbuckle 10" (25 cm) from the sprocket. Wrap the chain around the sprocket. The sprocket teeth must engage the chain as shown.

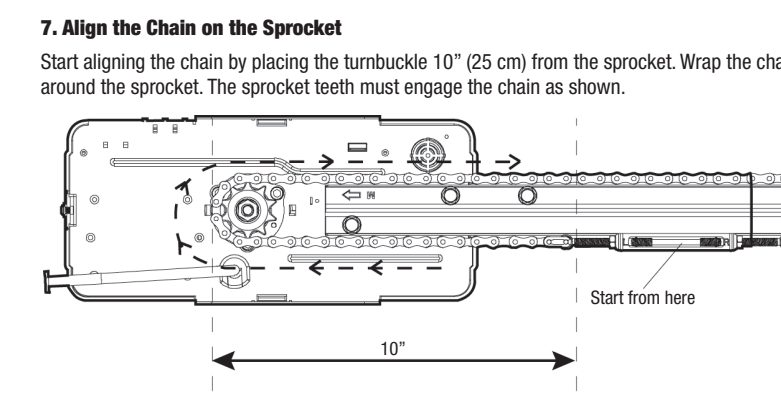

## ASSEMBLE THE T-RAIL

**8. Place the Cable on the Pulley**  
Place the cable around the pulley at the end of the rail. Ensure chain/cable passes through the trolley guides. Insert the trolley guides into the chain traveller until you hear a click when the chain traveller is completely seated into the trolley.

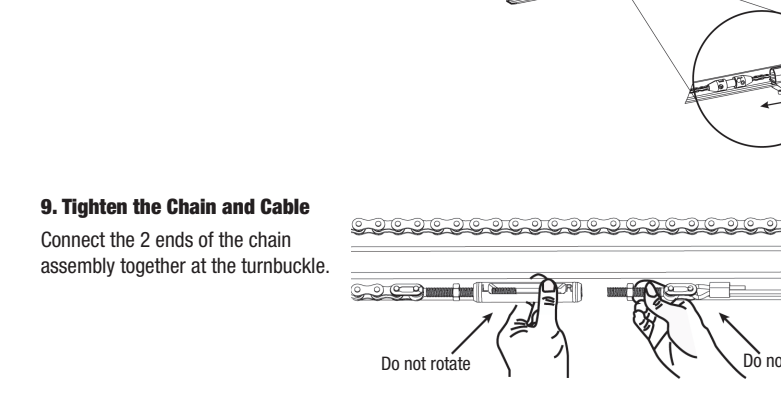

## ASSEMBLE THE T-RAIL

**9. Tighten the Chain and Cable**  
Connect the 2 ends of the chain assembly together at the turnbuckle.

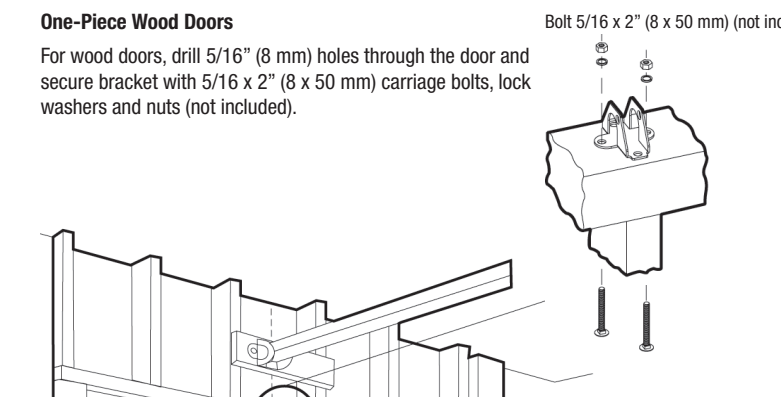

## INSTALL THE DOOR BRACKET

**One-Piece Wood Doors**  
For wood doors, drill 5/16" (8 mm) holes through the door and secure bracket with 5/16 x 2" (8 x 50 mm) carriage bolts, lock washers and nuts (not included).

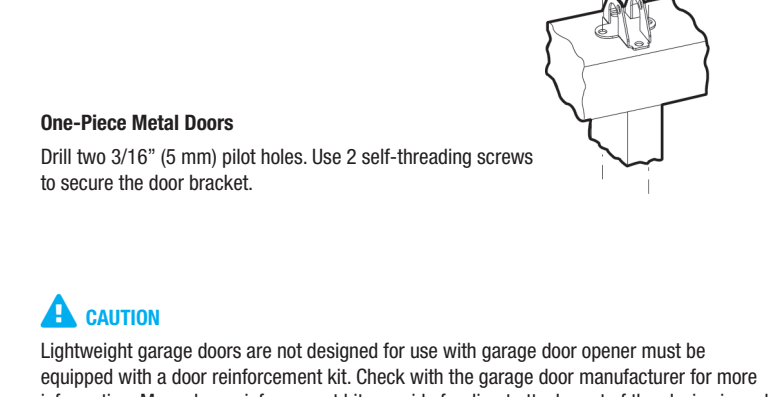

## INSTALL THE DOOR BRACKET

**Sectional Wood Doors**  
For wood doors, drill 5/16" (8 mm) holes through the door and secure bracket with 5/16 x 2" (8 x 50 mm) carriage bolts, lock washers and nuts (not included).

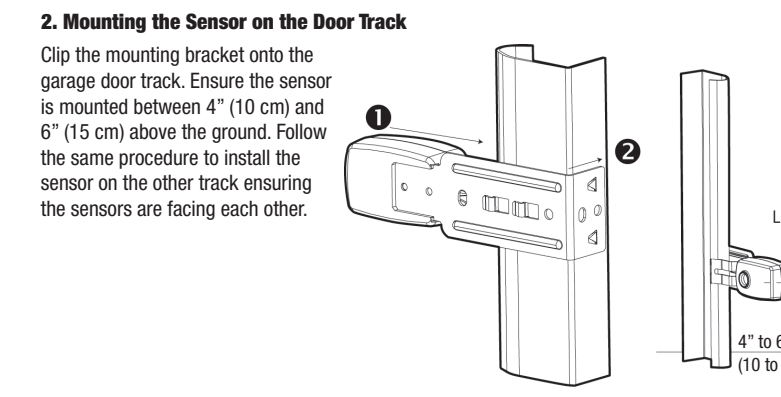

## INSTALL THE DOOR BRACKET

**One-Piece Metal Doors**  
Drill two 3/16" (5 mm) pilot holes. Use 2 self-threading screws to secure the door bracket.

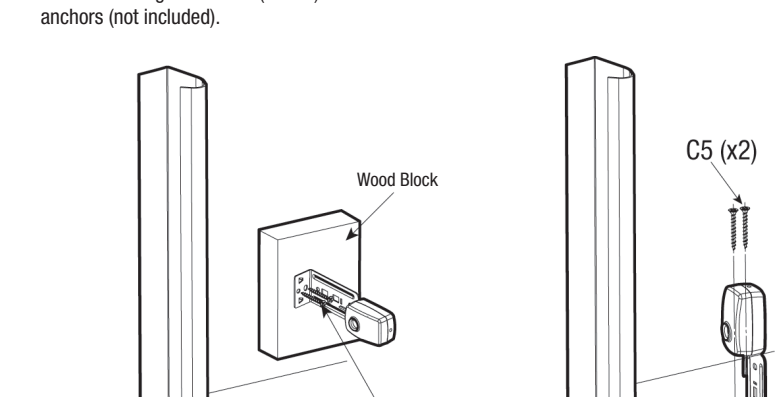

## INSTALL THE DOOR BRACKET

**Sectional Metal Doors**  
Align the door bracket on the centreline 2" to 4" (5 to 10 cm) below the top edge of the door, or directly below any door structural support.

## WHAT IS INCLUDED



## WHAT IS INCLUDED

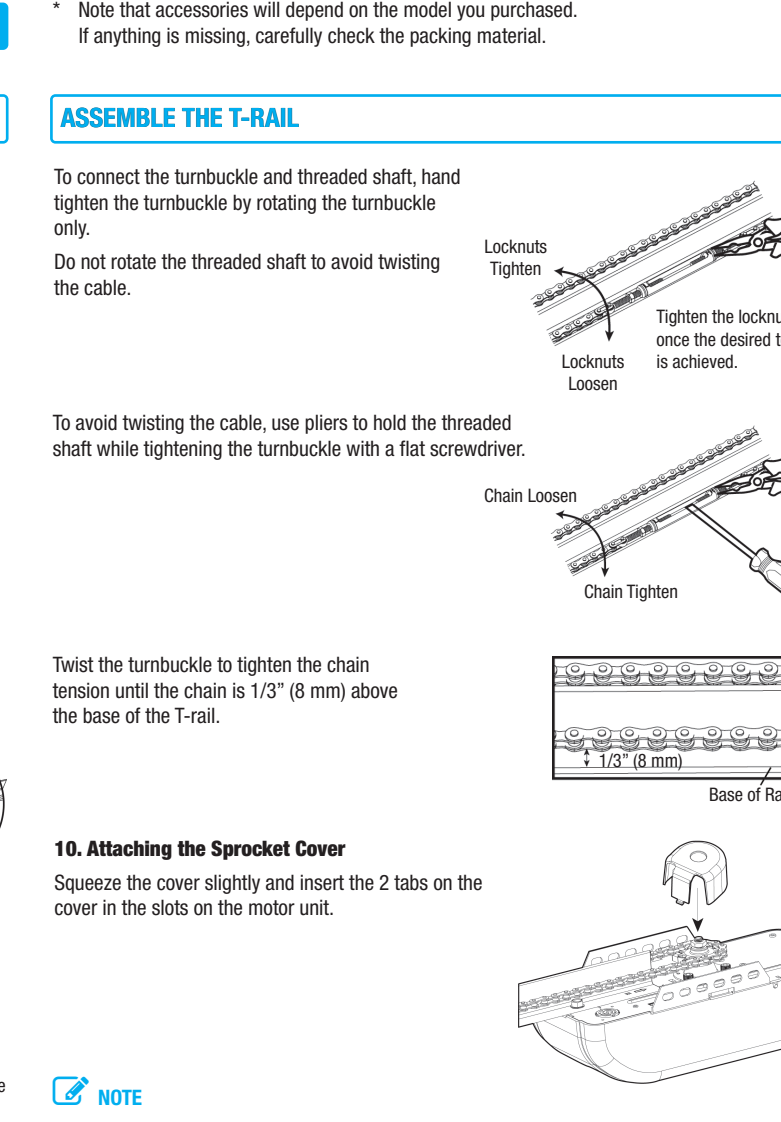

## WHAT IS INCLUDED

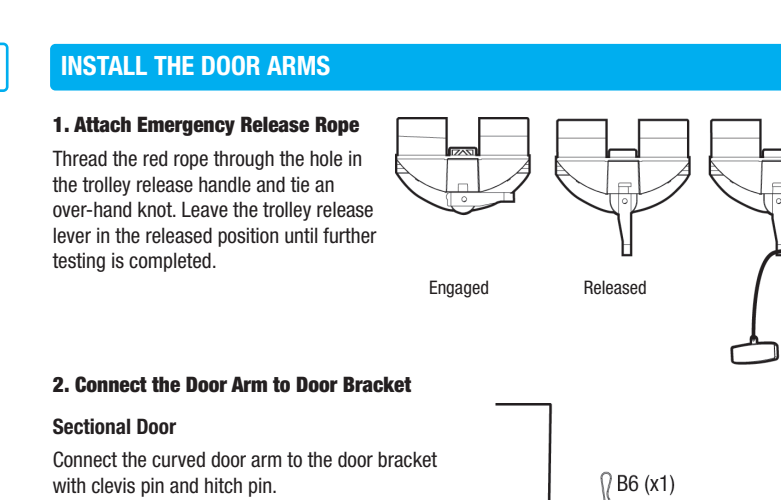

## INSTALL THE DOOR ARMS

**1. Attach Emergency Release Rope**  
Thread the rope through the hole in the trolley release handle and tie an over-hand knot. Leave the trolley release lever in the released position until further testing is completed.

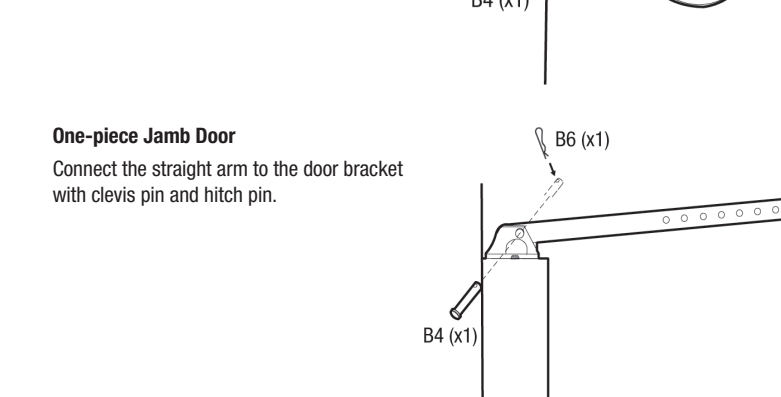

## INSTALL THE DOOR ARMS

**2. Connect the Door Arm to Door Bracket**  
Sectional Door  
Connect the curved door arm to the door bracket with clevis pin and hitch pin.

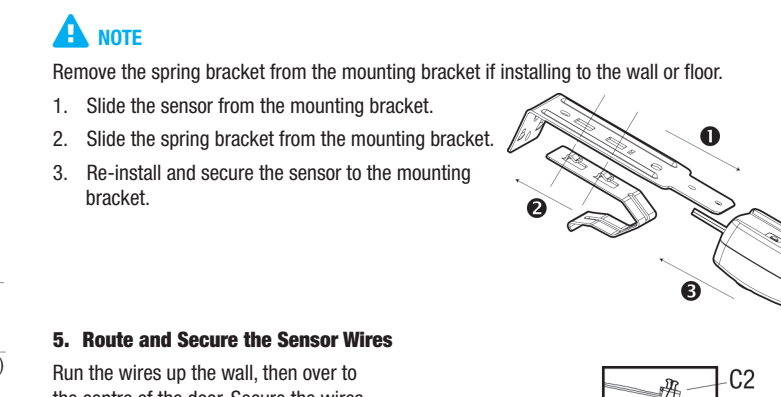

## INSTALL THE DOOR ARMS

**One-piece Jamb Door**  
Connect the straight arm to the door bracket with clevis pin and hitch pin.

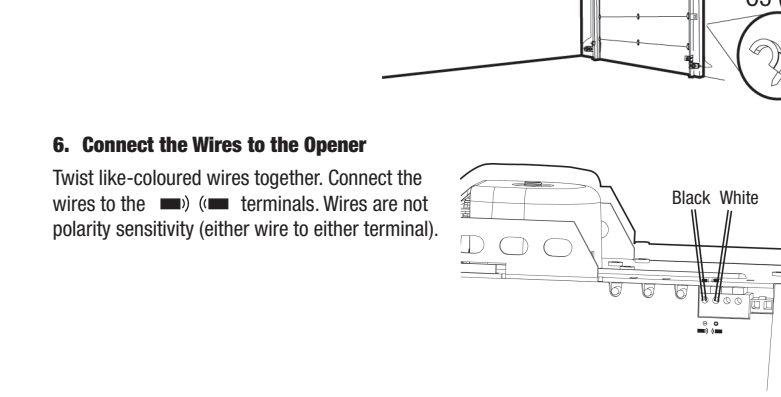

## INSTALL THE DOOR ARMS

**4. Connect the Door Arms Together**  
Bring two arms together. Find two pairs of holes that line up and join 2 arms with bolts and nuts. Select holes as far apart as possible to increase door arm rigidity.

## WHAT IS INCLUDED

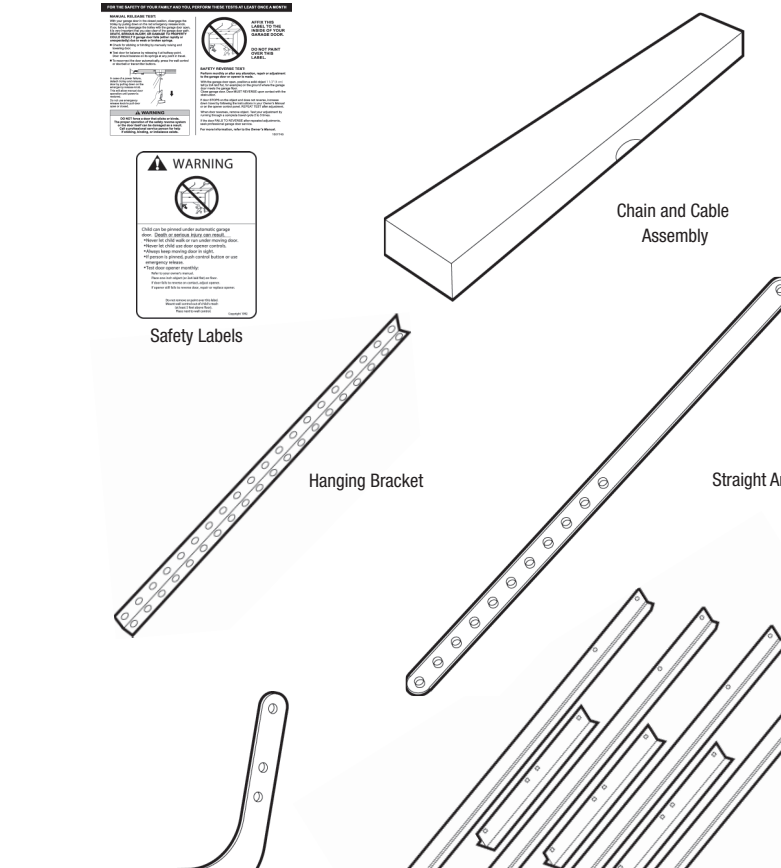

## WHAT IS INCLUDED

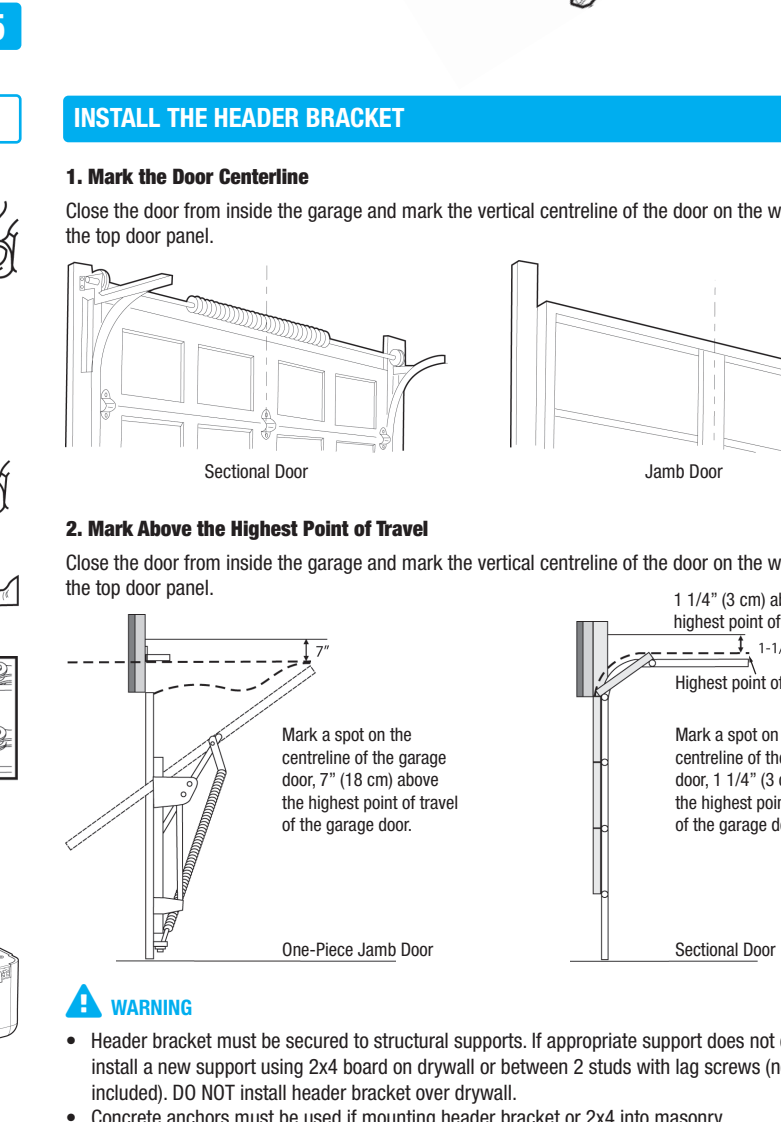

## INSTALL THE HEADER BRACKET

**1. Mark the Door Centerline**  
Close the door from inside the garage and mark the vertical centreline of the door on the wall and the top door panel.

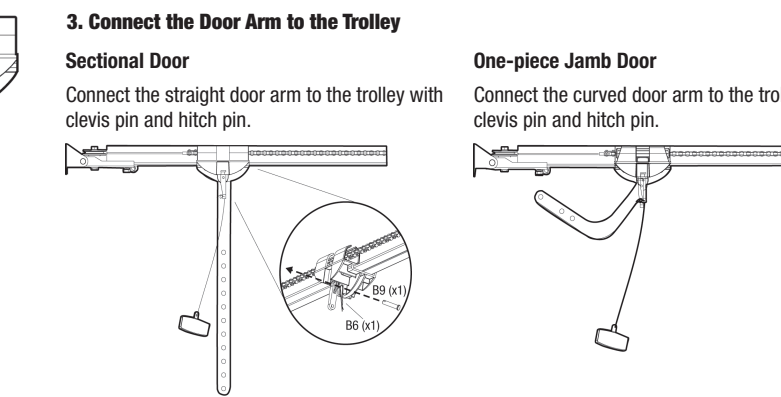

## INSTALL THE HEADER BRACKET

**2. Mark Above the Highest Point of Travel**  
Close the door from inside the garage and mark the vertical centreline of the door on the wall and the top door panel.

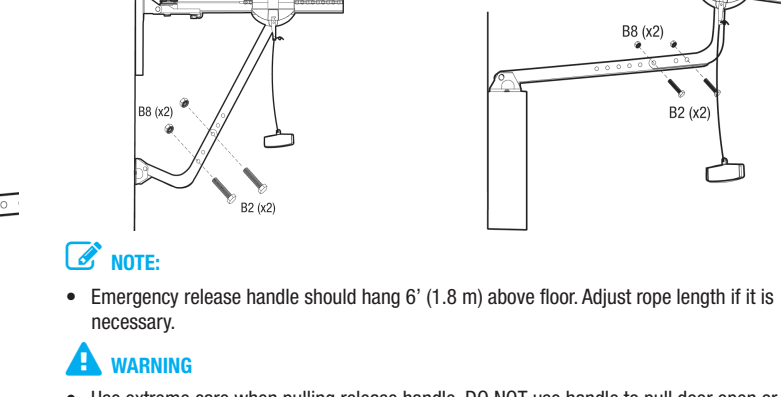

## INSTALL THE HEADER BRACKET

**4. Attach the Header Bracket**  
Place the bottom edge of the bracket on the line marked above the highest point of travel.

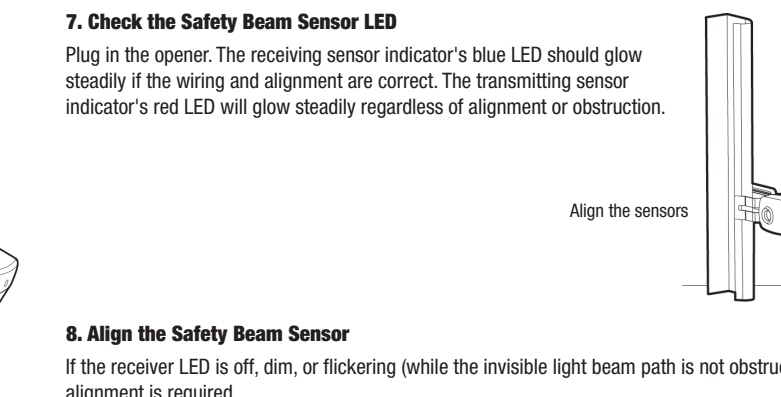

## INSTALL THE HEADER BRACKET

**3. Connect the T-Rail to the Header Bracket**  
Align the bracket holes and join with a clevis pin and hitch pin as shown.

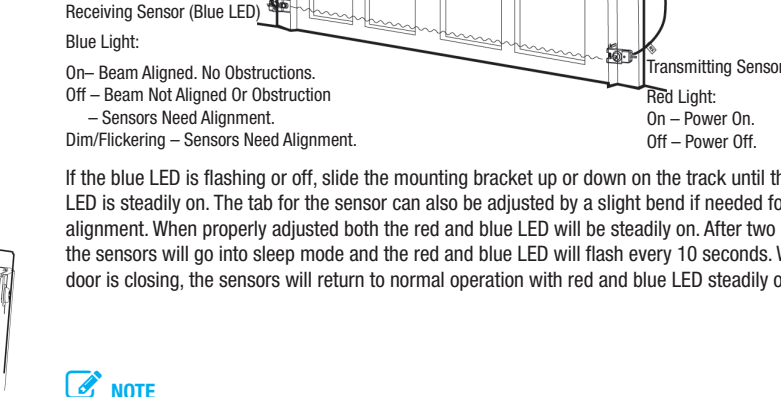

## INSTALL THE HEADER BRACKET

**5. Position the Opener**  
Position the pulley bracket against the header bracket. Position the opener on the floor with packaging material as protective base.

## WHAT IS INCLUDED

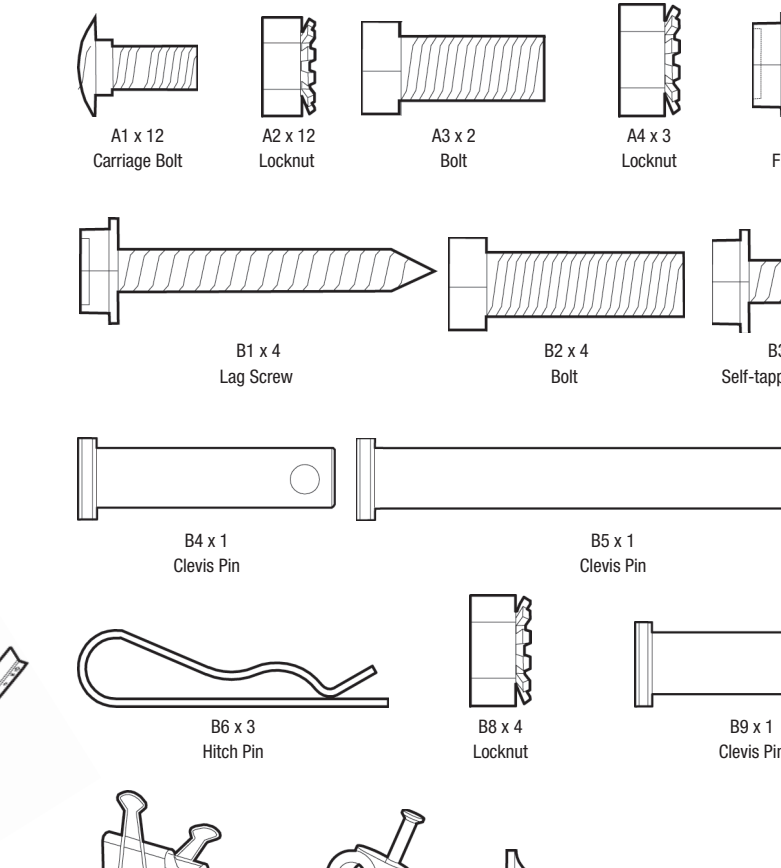

## WHAT IS INCLUDED

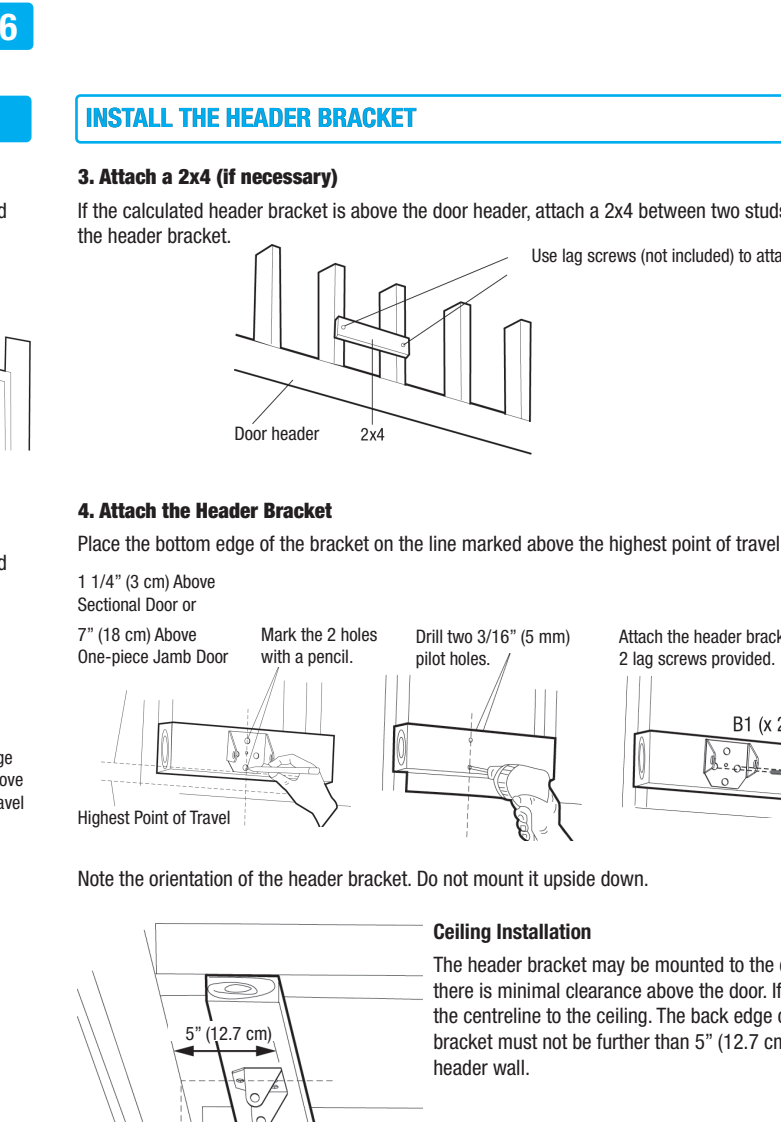

## INSTALL THE HEADER BRACKET

**3. Attach a 2x4 (if necessary)**  
If the calculated header bracket is above the door header, attach a 2x4 between two studs to install the header bracket.

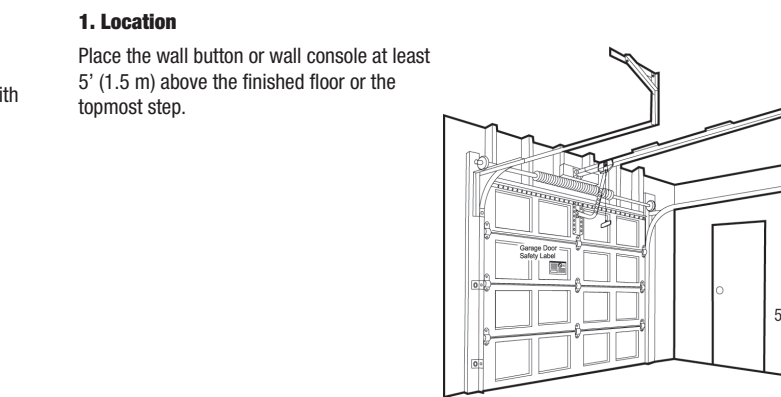

## INSTALL THE HEADER BRACKET

**4. Attach the Header Bracket**  
Place the bottom edge of the bracket on the line marked above the highest point of travel.

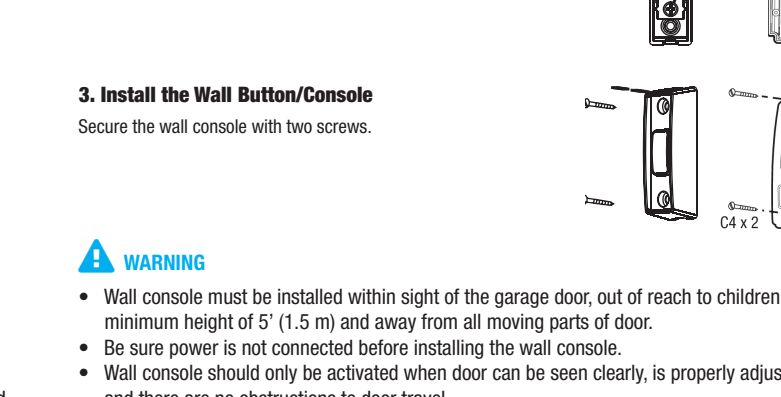

## INSTALL THE HEADER BRACKET

**6. Connect the T-Rail to the Header Bracket**  
Align the bracket holes and join with a clevis pin and hitch pin as shown.

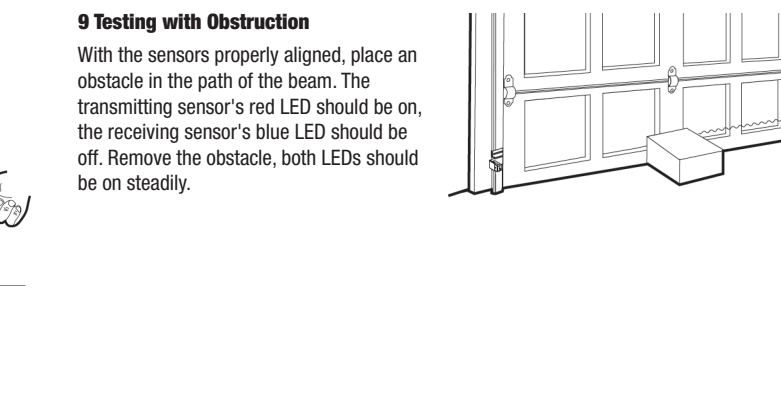

## INSTALL THE HEADER BRACKET

**8. Connect the Wires to the Opener**  
Connect the wires to the terminals. Wires are not polarity sensitivity (either wire to either terminals).

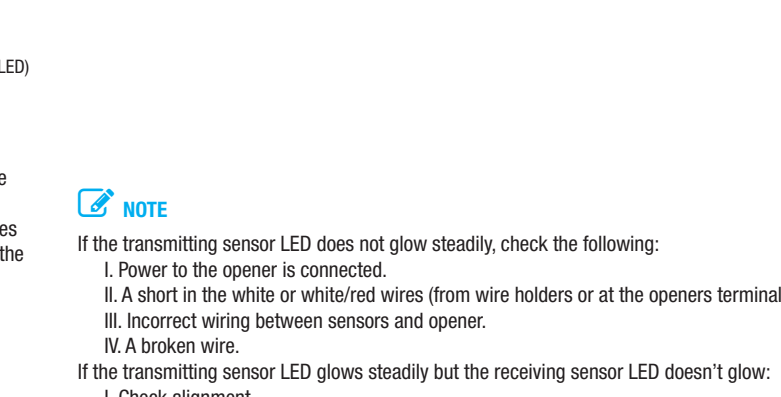

## INSTALL THE HEADER BRACKET

**9. Route and Secure the Wires**  
Route the wire up the wall and across the ceiling to the opener with wire holders.

## IMPORTANT INSTRUCTIONS

- To reduce the risk of severe injury or death:**
- READ AND FOLLOW ALL INSTALLATION INSTRUCTIONS.
  - Check with the door manufacturer to determine if additional reinforcement is required to support the door prior to installation of the garage door opener.
  - Install garage door opener only on a properly balanced garage door. An improperly balanced door could cause serious injury. Have a qualified service professional make repairs to garage door cables, spring assemblies and other hardware before installing the opener.
  - Remove all ropes and disable all locks connected to the garage door before installing opener.
  - Mount the emergency release handle 6' (1.8 m) above floor.
  - Do not connect the opener to source of power until this manual instructs you to do so.
  - Locate the wall console or wall console:
    - Within sight of the garage door.
    - Out of reach of children at minimum height of 5' (1.5 m).
    - Away from all moving parts of the door.
  - Place entrapment warning label on wall next to garage door wall control.
  - Install the Emergency Release Handle on the emergency release rope.
  - Place manual release/safety reverse test label in plain view on inside of garage door.
  - Upon completion of the installation, the door must reverse when it comes in contact with a 1 1/2" (3.8 cm) high object on the floor (or a 2x4 laid flat at the centre of the door) and when the infrared safety beam is blocked.

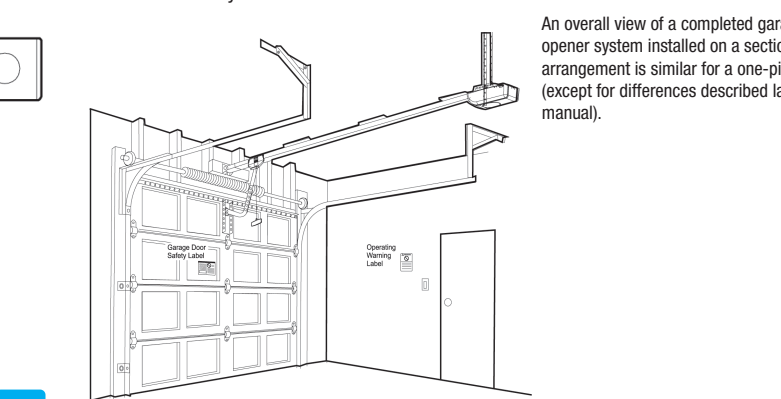

## IMPORTANT INSTRUCTIONS

**5. Position the Opener**  
Position the pulley bracket against the header bracket. Position the opener on the floor with packaging material as protective base.

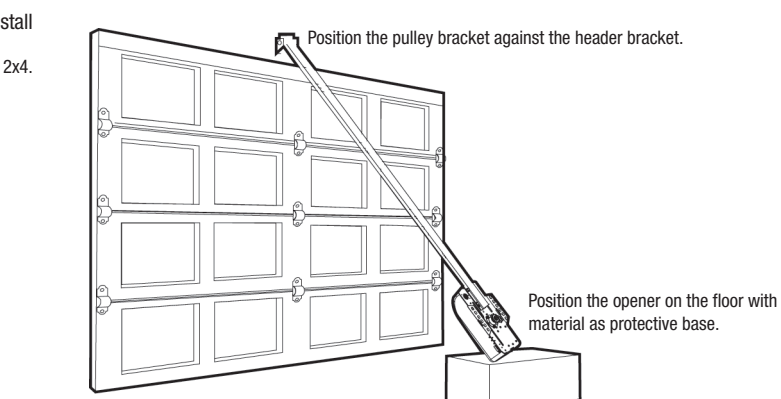

## INSTALL THE HEADER BRACKET

**6. Connect the Wires to the Opener**  
Connect the wires to the terminals. Wires are not polarity sensitivity (either wire to either terminals).

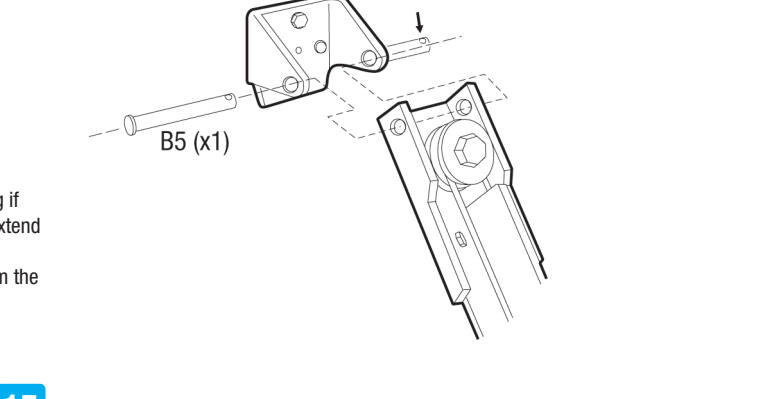

## INSTALL THE HEADER BRACKET

**8. Connect the Wires to the Opener**  
Connect the wires to the terminals. Wires are not polarity sensitivity (either wire to either terminals).

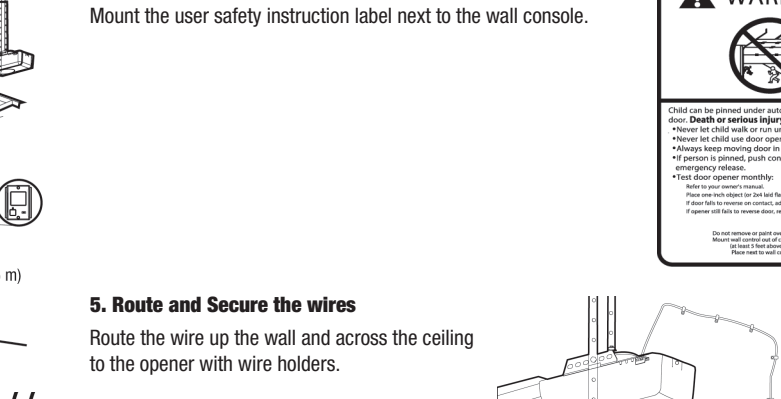

## INSTALL THE HEADER BRACKET

**9. Route and Secure the Wires**  
Route the wire up the wall and across the ceiling to the opener with wire holders.

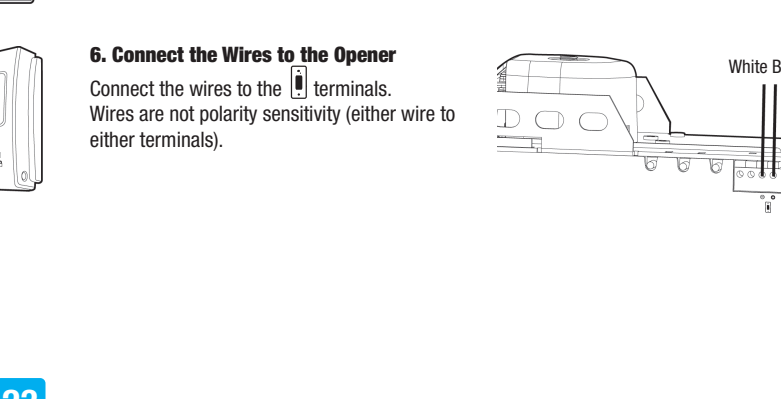

## INSTALL THE HEADER BRACKET

**6. Connect the Wires to the Opener**  
Connect the wires to the terminals. Wires are not polarity sensitivity (either wire to either terminals).



## INSTALL THE HEADER BRACKET

**9. Testing with Obstruction**  
With the sensors properly aligned, place an obstacle in the path of the beam. The transmitting sensor's red LED should be on, the receiving sensor's blue LED should be off. Remove the obstacle, both LEDs should be on steadily.



## INSTALL THE HEADER BRACKET

**6. Connect the Wires to the Opener**  
Connect the wires to the terminals. Wires are not polarity sensitivity (either wire to either terminals).



PROGRAMMING GUIDE – ATOMS™

A. Set Up Travel Limit and Open/Close Force

- 1. Connect the opener to an approved power source... 2. Press and hold [Learn/Set] button for 5 seconds... 3. Press the [UP] button until the door is in fully open position... 4. Press the [Learn/Set] button to confirm the door position... 5. The LED display will show the number "4". 6. Press the [DOWN] button until the door is in fully closed position... 7. Press the [Learn/Set] button again to confirm... 8. The LED light will flash 3 times when the travel limit settings are completed... 9. The LED display will show the number "3". 10. Press the wall button to open the garage door to its fully open position... 11. The LED light will flash 3 times.

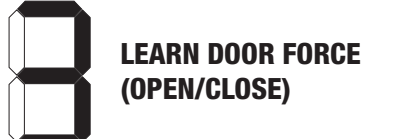
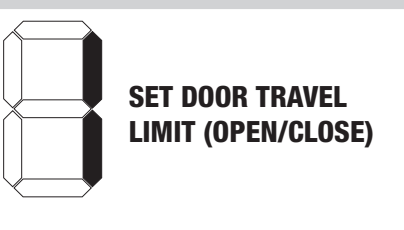
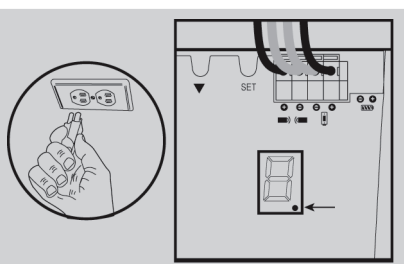

32

PROGRAMMING GUIDE – ATOMS™

B. Changing Force

- 1. Press and hold the [Learn/Set] button for 10 seconds... 2. The LED display will show "0". 3. Press the [UP] or [DOWN] button to set the force 0, 1, 2 or 3... 4. Press the [Learn/Set] button again to confirm the force is at the desired level.

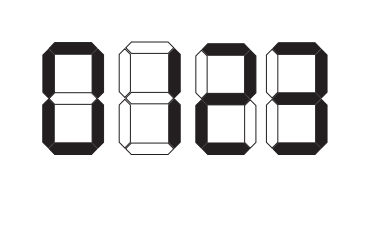

PROGRAMMING GUIDE – ATOMS™

C. Programming Remote Controls

- 1. Press the [Learn/Set] button for one second... 2. Program a Remote: Within 30 seconds, press any button on the remote... 3. Program a Wireless Keypad: Within 30 seconds, activate the keypad by entering: a. Pin code plus # for single door operation... b. Pin code plus [R] plus [Door No] for multiple door operation... 4. Once the button on the remote is programmed, the LED display will turn off and emit one beep indicating the programming has been successful.

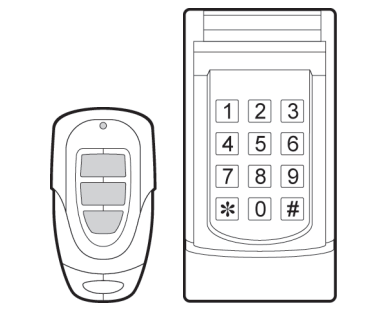

PROGRAMMING GUIDE – ATOMS™

D. Erasing all the Remote Controls from Opener

- Note: To erase any unwanted remote controls, first erase all remotes. 1. Press the [Learn/Set] button for 15 seconds... 2. Press the [Learn/Set] button again to confirm that erasing the programmed remotes has been successful. 3. Press the [Learn/Set] button for 15 seconds... 4. Press the [Learn/Set] button again to confirm that erasing the programmed remotes has been successful.

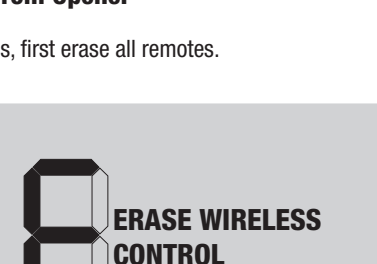

PROGRAMMING GUIDE – ATOMS™

E. Safety Test

- Test Safety Reversal System: With the door fully open, place a 1 1/2" (3.8 cm) board on the floor... 1. Place an obstacle (such as the opener carton) to break the safety infrared beam... 2. Press the push button to close the door... 3. The door should not move more than 1" (2.5 cm), and the opener light will flash... Test Safety Beam Sensor System: To test the safety beam sensor system, open the door to the fully open position... 1. Place an obstacle (such as the opener carton) to break the safety infrared beam... 2. Press the push button to close the door... 3. The door should not move more than 1" (2.5 cm), and the opener light will flash... 4. Ensure the obstacle is breaking the beam by checking the receiving sensor's blue LED is off... 5. If everything fails, call for a trained door systems technician.

OPERATIONS – ATOMS™

F. Important Safety Instructions

- WARNING: To reduce the risk of severe injury or death: 1. READ AND FOLLOW ALL INSTRUCTIONS CAREFULLY. 2. NEVER let children operate or play with any garage door controls or remote controls... 3. Always keep moving door in sight and away from people and objects until it is completely closed... 4. Only activate garage door when it can be seen clearly, is properly adjusted and there are no obstructions to door travel... 5. NEVER GO UNDER A STOPPED, PARTIALLY OPEN DOOR. 6. Test the door opener monthly... 7. If possible, use the red emergency release only when the door is closed... 8. Never use the emergency release rope to pull garage door open or closed... 9. KEEP GARAGE DOORS PROPERLY BALANCED... 10. Disconnect the electrical power to the garage door opener before making any repairs... 11. The operator system is equipped with an unattended operation feature... SAVE THESE INSTRUCTIONS.

OPERATIONS – ATOMS™

G. Operating the Door

- Activate your opener with any of the following: 1. Press the wall console 2. Press the assigned button on the remote control. Depends on the status of the garage door opener and the position of the garage door... 1. If the door is closed, activating it will open the door... 2. If the door is open, activating it will close the door... 3. If the door is closing, activating it will stop the door... 4. If the door is opening, activating it will stop the door... If the door is obstructed during operation, the garage door opener will: 1. If obstructed while opening, the door will stop... 2. If obstructed while closing, the door will reverse... 3. The opener light will flash if the opener is obstructed during operation. Opener Light: The opener light will turn on: 1. When the opener is plugged in... 2. When the opener is activated... You can manually turn on the light with the Wall Console, Wall Button section of the instructions.

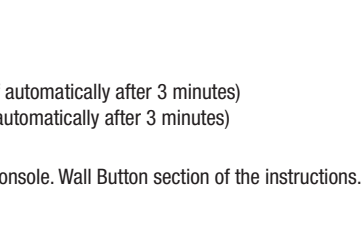
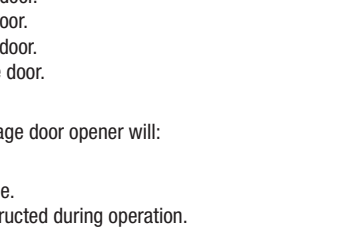
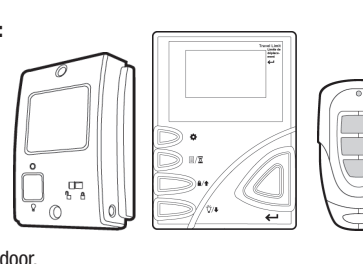

OPERATIONS – ATOMS™

H. Remote Control

- To activate the opener with the remote control, hold down the button until the door begins to move... To Open the Door Manually: In case of a power failure or if the door becomes obstructed, pull the red trolley release handle to disengage the opener from the door... Use caution if the door is open while disengaging, the door may drop.

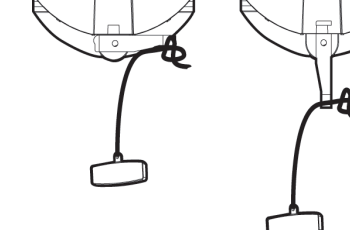
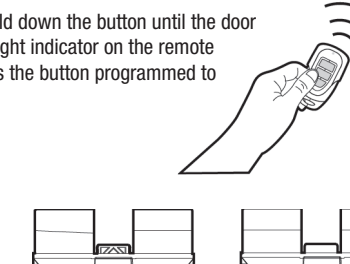

MAINTENANCE

- Once a Month: Test the door balance... Check to be sure door opens and closes fully... Once Every Six Months: Check the Chain Tension... Once a Year: Oil the door rollers, bearings and hinges. Battery Replacement: All remotes come with battery installed... To replace the battery: Undo the two screws on the back of the remote... Take out the old battery. 1. Place the new battery in position. 2. Close the cover and reinsert two screws.

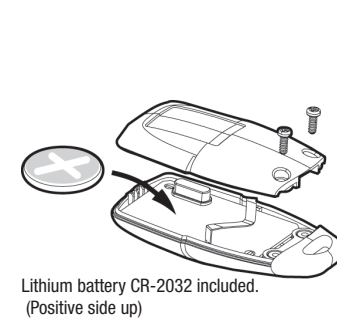

40

BACKUP BATTERY

- Backup Battery: 1. Press the latch inwards to release the cover. 2. Remove the cover. 3. Take out the battery and connect the wires to the battery terminal tabs... 4. Red wire connects to red terminal tab (+). 5. Black wire connects to the black terminal tab (-). 6. Place the battery back into the battery compartment. 7. Close the cover. Install the Metal Hanger: 1. Unplug the garage door opener from power before proceeding. 2. Use the screws and nuts to mount the metal hanger to the operator mounting plate. 3. Affix a cushion at the side of the hanger. 4. Install the backup battery unit to the metal hanger.

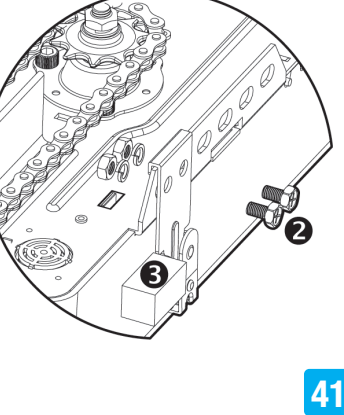
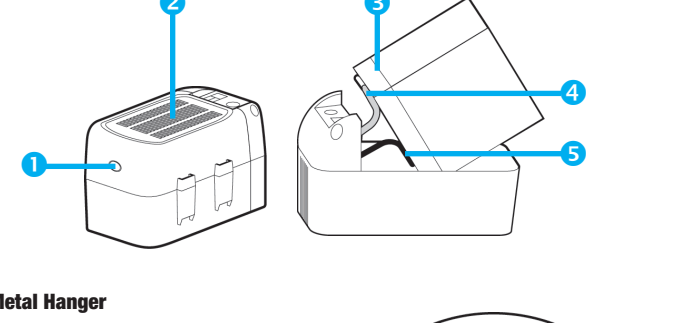

41

BACKUP BATTERY

- NOTE: These steps must be performed in this exact order very carefully to prevent a short in the battery by accident. Connecting the battery backup unit to the garage door opener unit: 1. Connect the 2-wire harness to the garage door opener unit... 2. Red wire connects to the "+" terminal. 3. Black wire connects to the "-" terminal. 4. Insert the 2-wire harness to the battery backup unit. Testing the Battery: 1. Turn on the battery backup switch. 2. Unplug the garage door opener from the AC power. 3. Activate the garage door opener... 4. Plug the garage door opener back in.

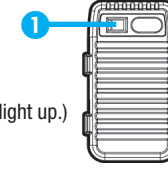
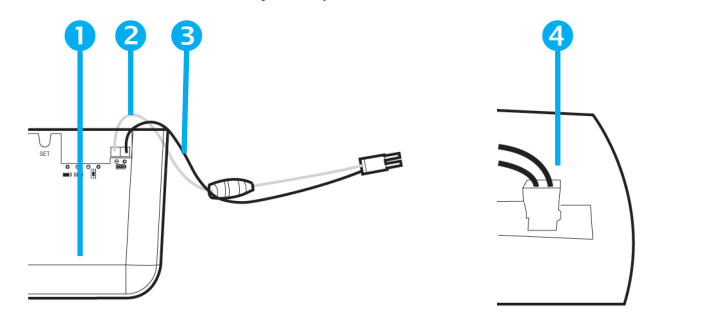

42

BACKUP BATTERY

- Battery Status: LIGHT STATUS STATUS ACTION: 3 Flashes Red LED flashing slowly: Fully charged (AC adaptor is unplugged). Ready to provide power to garage door opener. 5 Flashes Red LED staying on: Backup battery is weak (AC adaptor is unplugged). Needs to re-charge. Blue LED flashing slowly: Backup battery is being charged (AC adaptor is plugged in). Charging. Blue LED staying on: Fully charged (AC adaptor is plugged in). Ready to use. Blue LED flashing quickly and while LED flashing slowly: Backup battery is not installed (AC adaptor is plugged in) or switch is not turned on. Re-install the backup battery... White LED flashing 3 times quickly: Garage door opener is being affected by power outage. Garage door opener will operate in 'battery backup' mode. Charging the Battery: 1. The battery unit will take 24 hours to fully charge... 2. Plug the AC adaptor (provided) into an AC outlet... 3. To obtain maximum battery life and prevent any damage, turn off the battery backup unit when the garage door opener is unplugged for a long period of time.

- NOTE: Door operation may be limited if the battery is not fully charged, or the Backup Battery light may not turn on during battery operation.

43

TROUBLESHOOTING

Table with 4 columns: LED LIGHT FLASHING, LED DISPLAY FLASHING, SYMPTOM, SOLUTION. Rows include: 3 Flashes (Wall console lock), 5 Flashes (Obstruction detected), 10 Flashes (Safety beam sensor blocked), 15 Flashes (Door not fully open), Continuous Flashing (Wall console wire shorted).

36

TROUBLESHOOTING

- Opener does not operate from either wall console or remote: 1. Check the opener's AC outlet has power... 2. Check the wall console wiring at the wall console's and opener's terminals... Opener tries to operate, but the door does not move: 1. A door spring may have been broken... 2. In cold weather climates, check that the door is not frozen... Opener operates from remote but not from wall console: 1. Ensure the wiring connections are correct... 2. Is the wall console lit? If not, disconnect low voltage wires... Opener operates from wall console but not remote: 1. Is the wall console in lock mode? 2. Does remote indicator light glow when remote button is pressed? 3. Has the opener learned the code of the remote? Door does not open completely: 1. Is something obstructing the door? 2. Is the door area is free of persons and any other objects... Door does not close completely: 1. Is something obstructing the safety beam sensor?

37

TROUBLESHOOTING

- Opener light stays on: 1. It is normal for the opener's light to stay on for about 3 minutes after each activation... Opener activates by itself: 1. Check all remotes programmed into the opener... 2. Check the wiring between the wall console and the opener... Door reverses for no apparent reason: 1. The door hardware may be binding... 2. Re-adjust the travel limits and force adjustments... Opener is noisy: 1. Adjust the chain tension... Opener won't work due to power failure: 1. Use the emergency release handle to disconnect the opener from the door.

38

ACCESSORIES

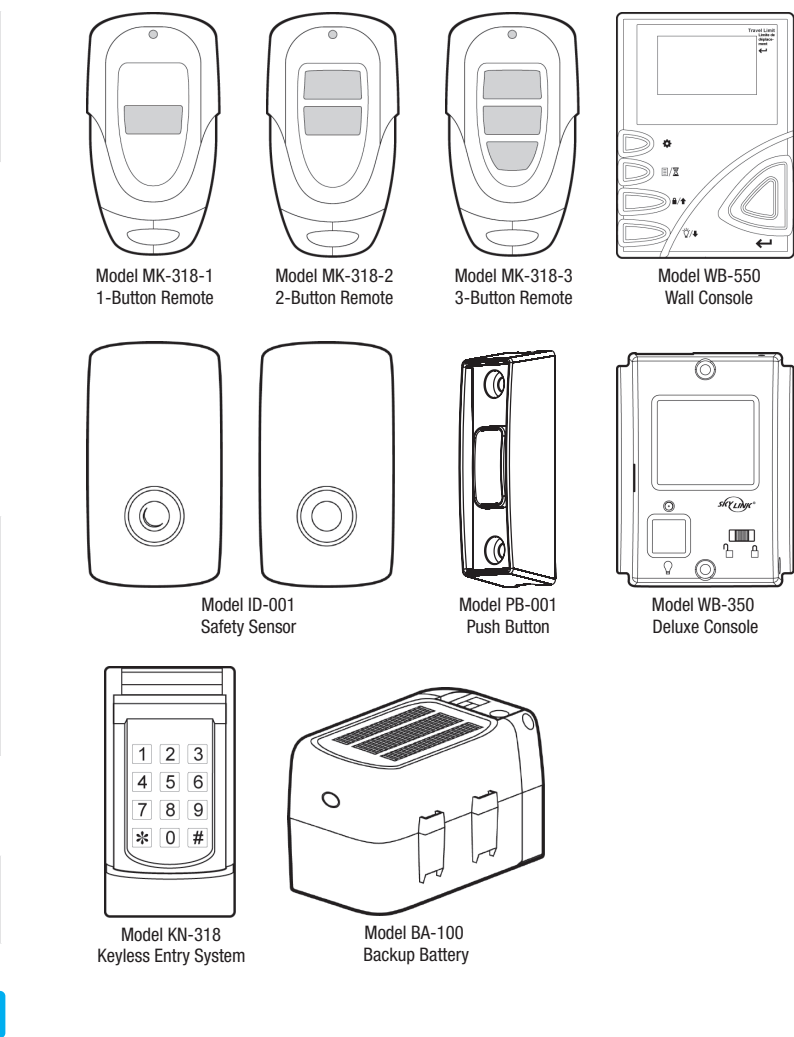

39

FCC

This device complies with Part 15 of the FCC Rules. Operation is subject to the following two conditions: (1) This device may not cause harmful interference and (2) This device must accept any interference received, including interference that may cause undesired operation.

WARNING: Changes or modifications to this unit not expressly approved by the party responsible for compliance could void the user's authority to operate the equipment.

NOTE: This equipment has been tested and found to comply with the limits for a Class B digital device, pursuant to Part 15 of the FCC Rules. These limits are designed to provide reasonable protection against harmful interference to radio or television reception... 1. Reorient or relocate the receiving antenna. 2. Increase the separation between the equipment and receiver. 3. Connect the equipment into an outlet on a circuit different from that to which the receiver is connected. 4. Consult the dealer or an experienced radio/TV technician for help.

48

LIMITED WARRANTY

Skylink Group (the Company) warrants to the original purchaser that products delivered hereunder will be free of defects in material and workmanship for the period listed below from the date of purchase. Electronics & Mechanical: 1 Year Motor: Refer to the sales agreement. THE COMPANY MAKES NO OTHER WARRANTY OR REPRESENTATION OF ANY KIND WHATSOEVER EXPRESS OR IMPLIED... SOME STATES DO NOT ALLOW LIMITATIONS ON INCIDENTAL OR CONSEQUENTIAL DAMAGES...

49

SKYLINK™ CUSTOMER SERVICE

MONDAY-FRIDAY 9:00 AM - 5:00 PM EST 1-800-304-1187 support@skylinkhome.com SKYLINKHOME.COM

17 SHEARD AVENUE • BRAMPTON, ONTARIO • CANADA L6Y 1J3

50

Tested To Comply With FCC Standards

48

©2015 SKYLINK GROUP

49